

CR-48 Rub Rail

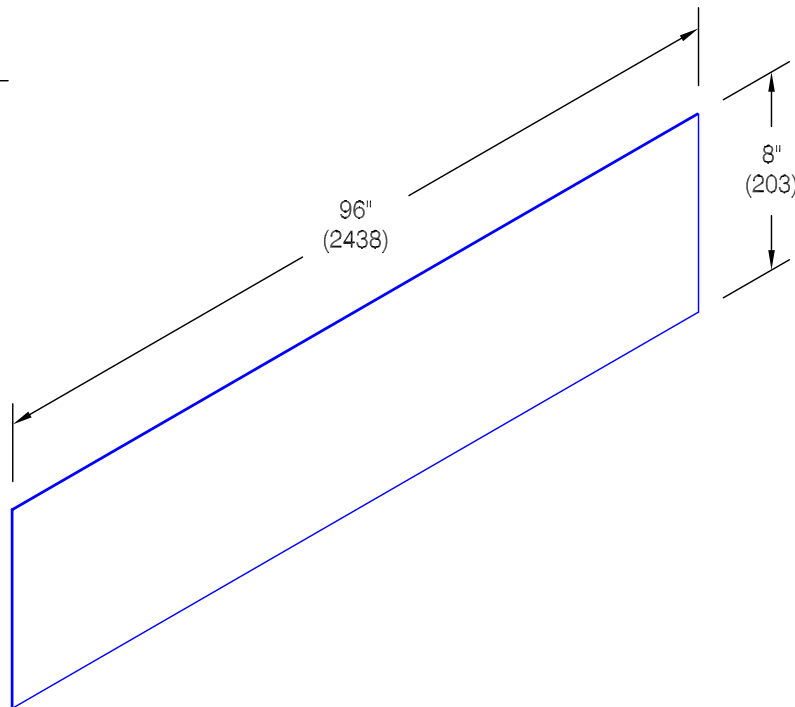
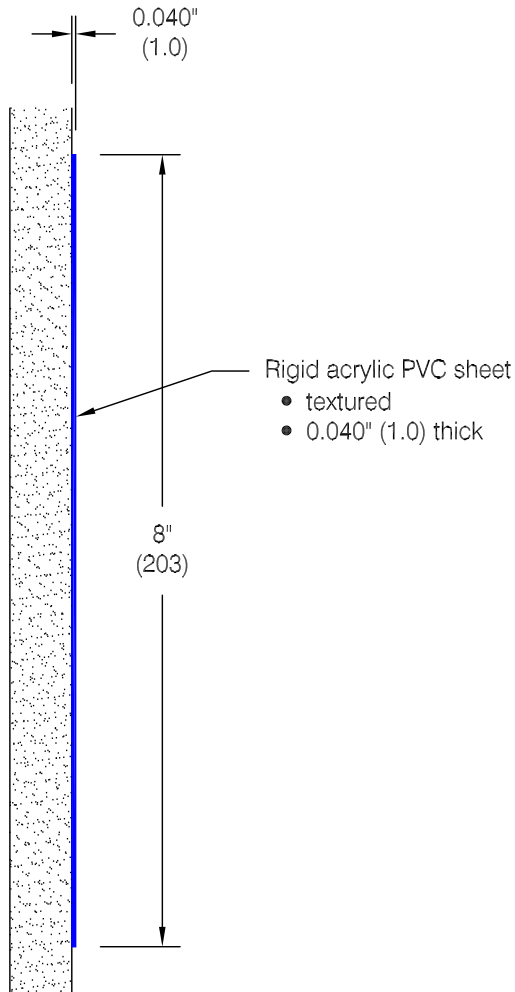

Features:

- Class A fire rating
- Heavier gauges available
- Stock length 8'-0" (2438)

Finishes:

- Manufacturer's Standard colors
- Custom colors available

Mounting Options:

- Adhesive
 ADH-30 Contact adhesive or
 ADH-60 Mastic adhesive supplied
 separately as required
- Drilled
 Clearance holes for
 ABSS-80 #8 x 1 1/4" (32) pan head
 sheet metal screw supplied
 separately as required
- Taped
 ADH-4042 double sided adhesive
 tape factory applied to rub rail

Pawling Corporation reserves the right to discontinue a design or modify an existing design without prior notice

Customer :	Project :	WD.41.0a
Architect :	Sales Rep :	