

BR-5EM Handrail

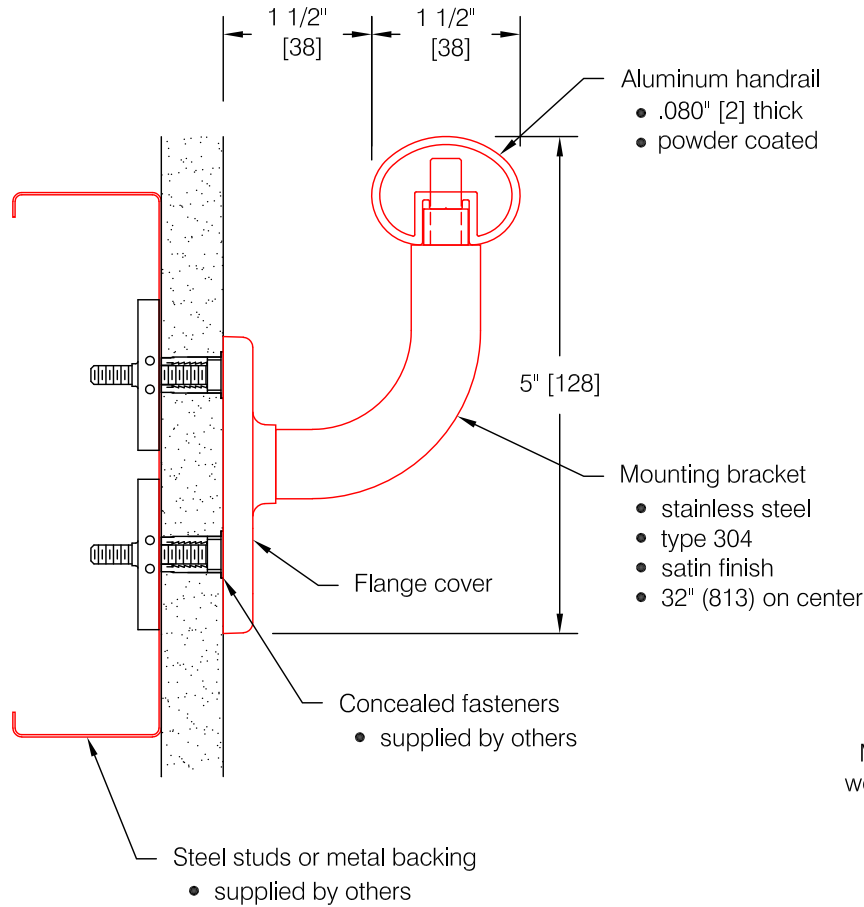

Features:

- ADA Compliant
- Cast aluminum wall returns
- Cast aluminum corners
- Stock length 12'-0" (3658)

Finishes:

Handrail

- Powder coated aluminum
- Manufacturer's standard colors
- Custom colors available

Bracket

- Satin finish stainless steel

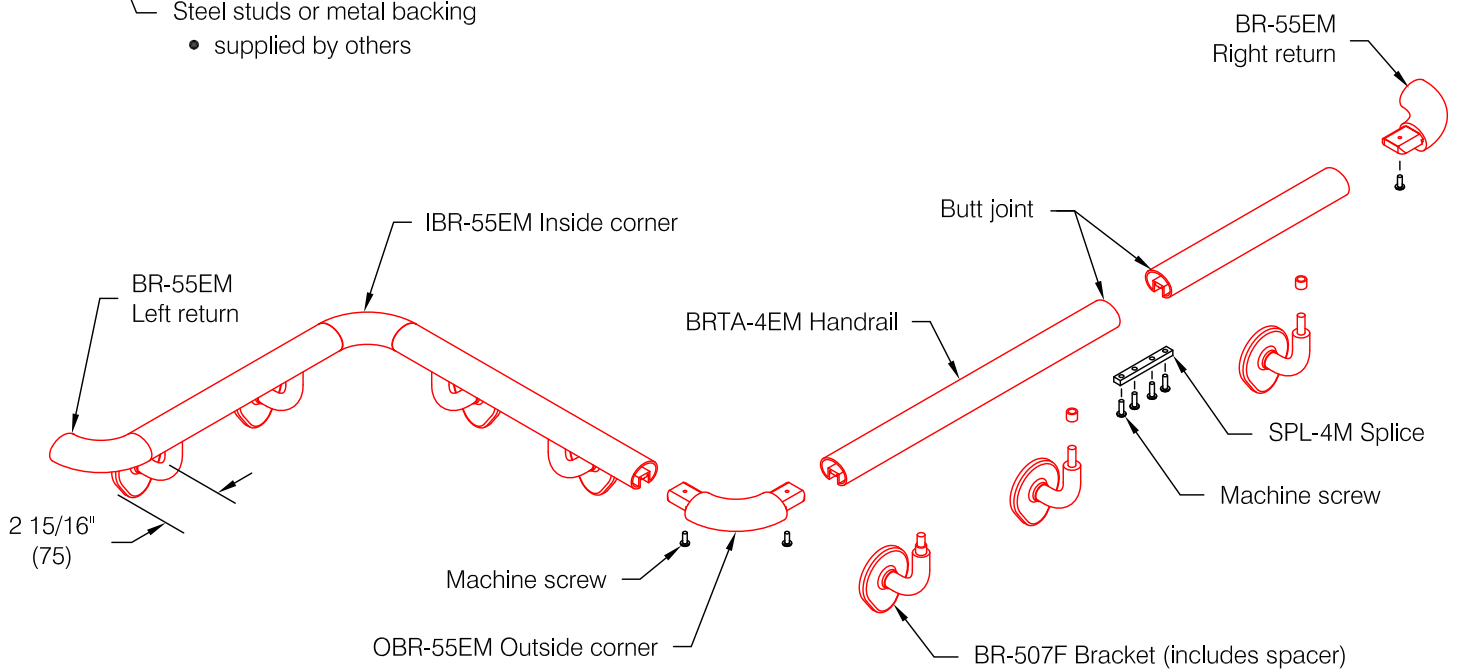
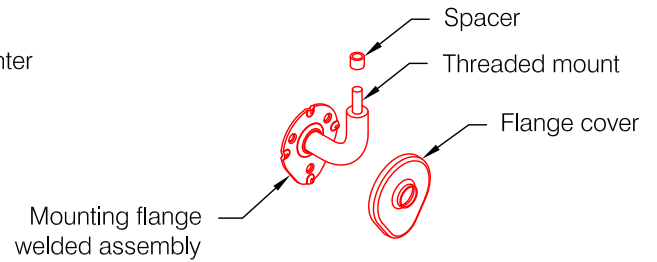

Pawling Corporation reserves the right to discontinue a design or modify an existing design without prior notice

Customer :	Project :	WD.233.0
Architect :	Sales Rep :	