

# CG-2.0 Corner Guard

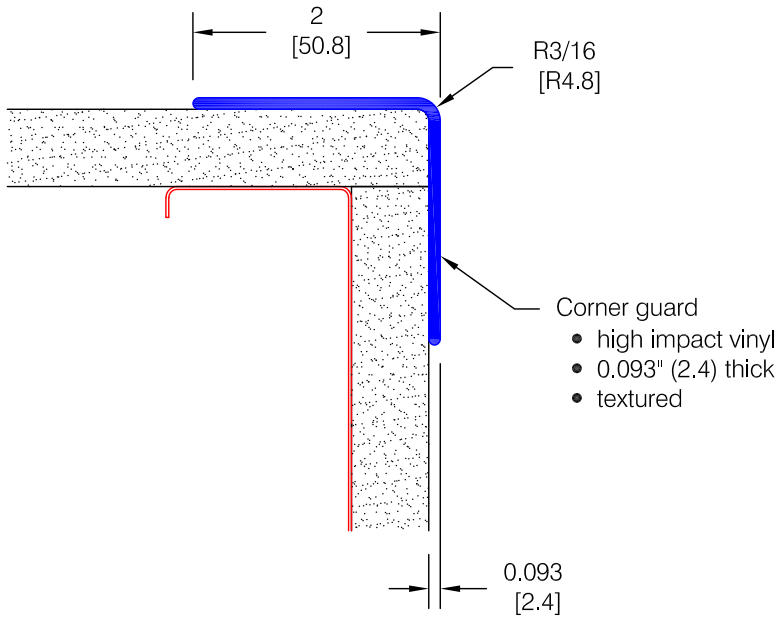

### Features:

- Class A fire rating
- Stock lengths:  
 4'-0" (1219), 6'-0" (1829)  
 8'-0" (2438) & 12'-0" (3658)

### Finishes:

- Manufacturer's standard colors
- Custom colors available

### Available Mounting Options:

- Adhesive, with CGU-2.0 construction adhesive supplied separately
- Mechanical Fasteners, with CGD-2.0 countersunk for #6 x 1 1/2" (38) oval head screws, supplied separately
- Adhesive Tape, on CGT-2.0 double sided adhesive tape factory applied to corner guard
- See alternative mounting details at left

### Alternative Mounting

#### CGU-2.0

- standard offering
- undrilled, untaped

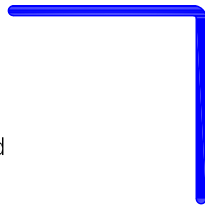

#### CGT-2.0

- factory applied adhesive tape
- on inward face of each leg

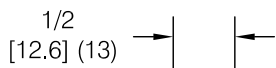

#### CGD-2.0

- countersunk for #6 fastener
- 1" (25) from each end, spaced evenly not to exceed 36" (914)

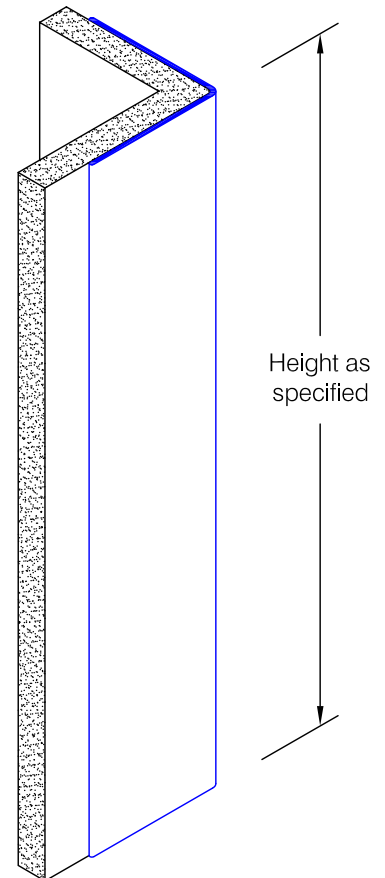
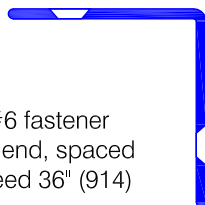

Pawling Corporation reserves the right to discontinue a design or modify an existing design without prior notice

Customer :	Project :	WD.211.1a
Architect :	Sales Rep :	