

CG-14 Corner Guard

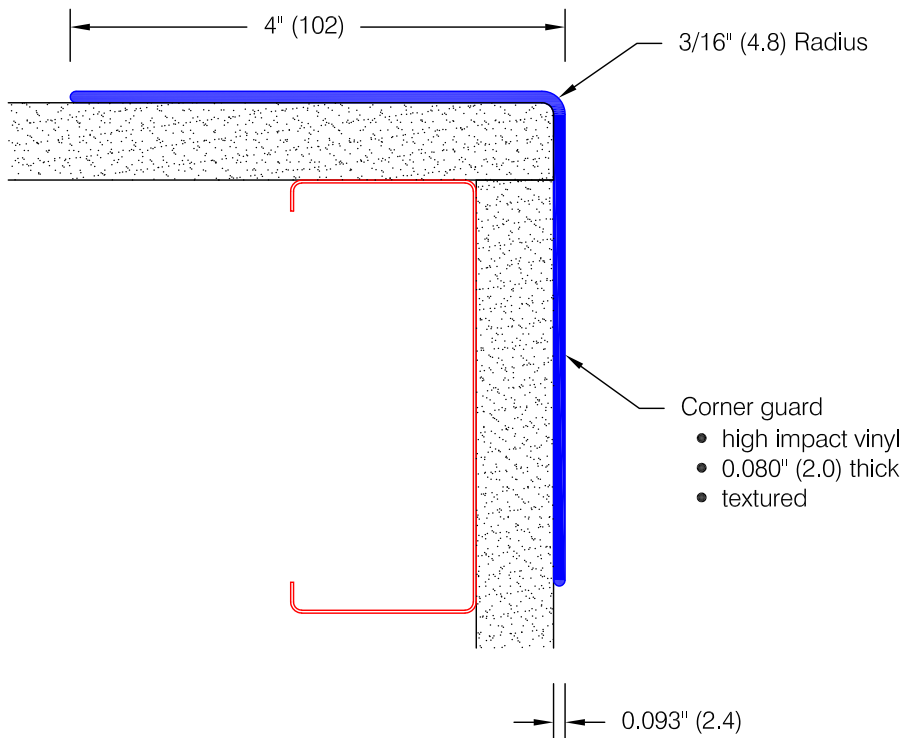

Features:

- Class A fire rating
- Stock lengths:
4'-0" (1219), 8'-0" (2438) & 12'-0" (3658)

Finishes:

- Manufacturer's standard colors
- Custom colors available

Available Mounting Options:

- Adhesive, with CGU-14 construction adhesive supplied separately
- Mechanical Fasteners, with CGD-14 countersunk for #6 x 1 1/2" (38) oval head screws, supplied separately
- Adhesive Tape, on CGT-14 double sided adhesive tape factory applied to corner guard
- See alternative mounting details at left

Alternative Mounting

- CGU-14**
- standard offering
 - undrilled, untaped

- CGT-14**
- factory applied adhesive tape
 - on inward face of each leg

1/2" (13)

- CGD-14**
- countersunk for #6 fastener
 - 1" (25) from each end, spaced evenly not to exceed 36" (914)

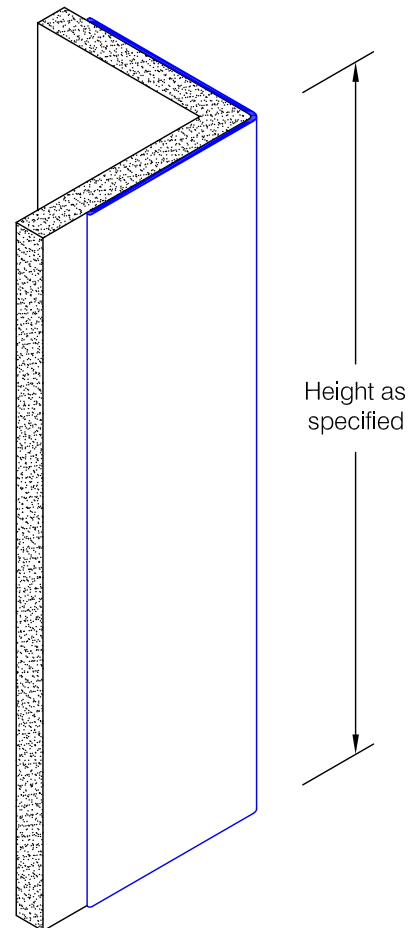

Pawling Corporation reserves the right to discontinue a design or modify an existing design without prior notice

Customer :	Project :	WD.112.0b
Architect :	Sales Rep :	