

# MRF-1002 Aluminum Recessed Frame

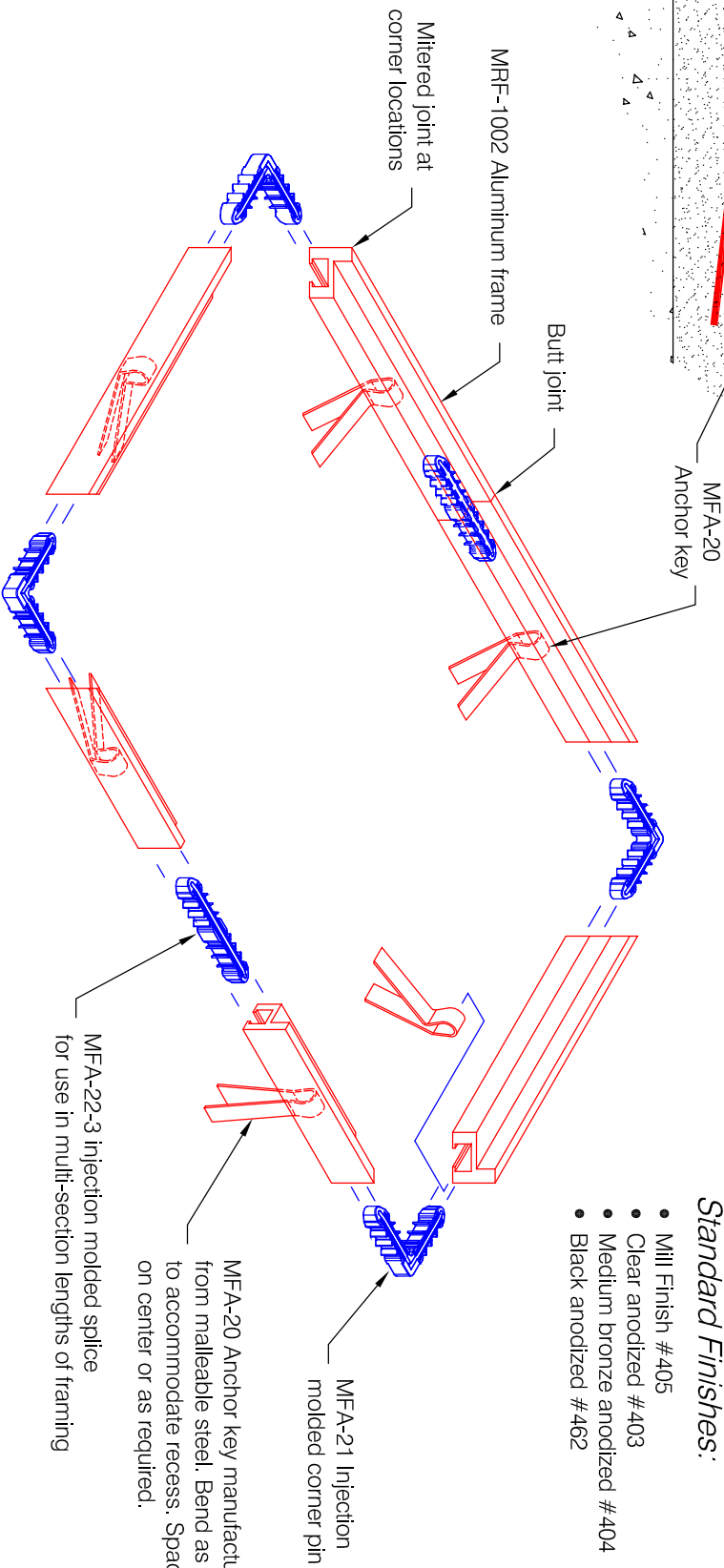
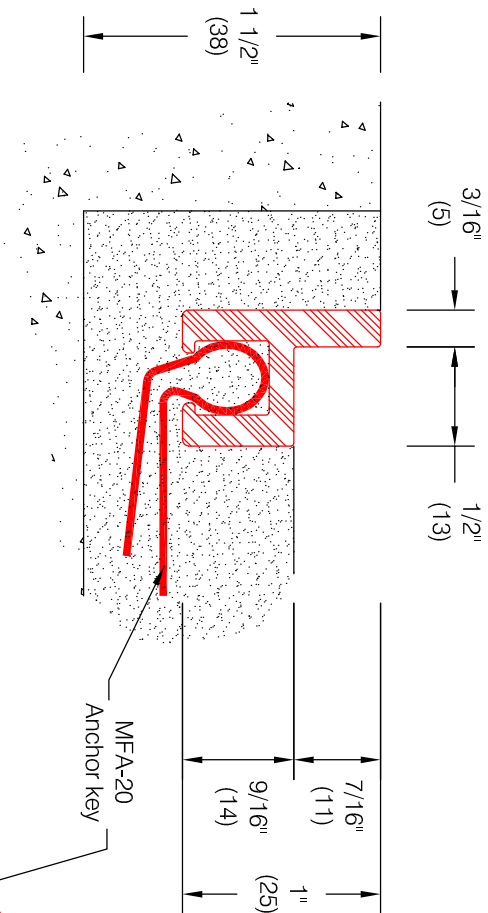

**Features:**

- Use for Rol-Dek<sup>®</sup> or other 3/8" (10) through 5/8" (16) thick mats
- Extruded aluminum alloy 6063-T5
- Stock length: 16'-6" (5029)
- Weight: 0.4 lbs / lf

**Installation Options:**

- Recessed, cast in place

**Standard Finishes:**

- Mill Finish #405
- Clear anodized #403
- Medium bronze anodized #404
- Black anodized #462

MFA-20 Anchor key manufactured from malleable steel. Bend as required to accommodate recess. Spaced 24" (610) on center or as required.

MFA-22-3 injection molded splice for use in multi-section lengths of framing

*Pawling Corporation reserves the right to discontinue a design or modify an existing design without prior notice*

Customer :  
Architect :

Project :  
Sales Rep :

ED.1.0d