

BR-600C Series Handrail

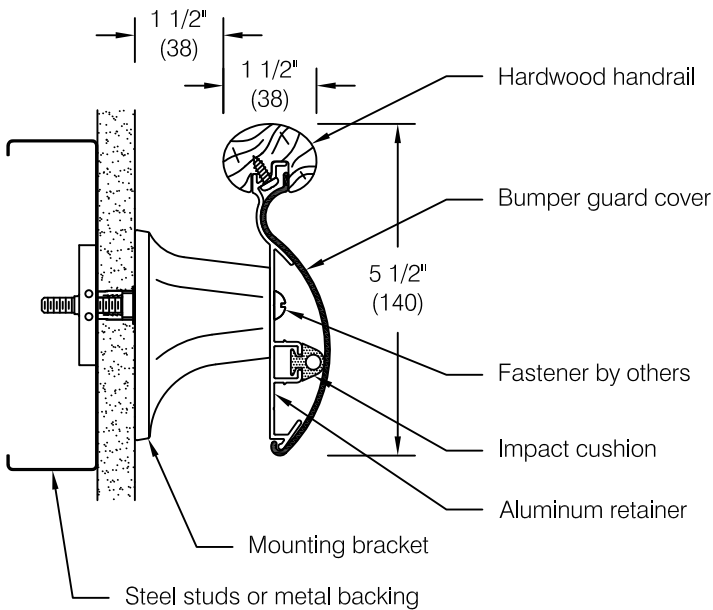

This installation instruction is applicable to:

BR-600C

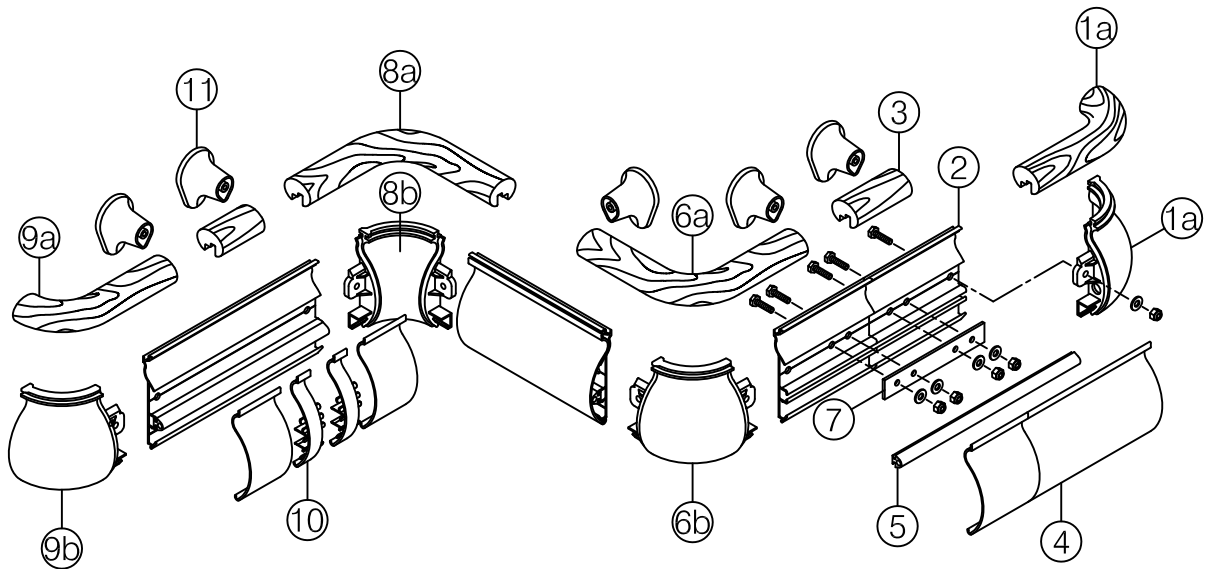

Component Part Numbers:

- | | |
|--------------------------------|--|
| 1) BR-625C Right return | 7) SPL-600 Splice |
| 1a. BRR-625 Wood top (loose) | 8) IBR-675C Outside corner |
| 1b. Molded base | 8a. ICW-675 Wood top (loose) |
| 2) BRA-600C Aluminum retainer | 8b. Molded base |
| 3) BRW-600 Wood handrail | 9) BR-625C Left return |
| 4) BRBV-600 Bumper guard cover | 9a. BRL-625 Wood top (loose) |
| 5) B-100 Impact cushion | 9b. Molded base |
| 6) OBR-650C Outside corner | 10) ACC-600 Vertical accent (optional) |
| 6a. OCW-650 Wood top (loose) | 11) BR-108 Wall mount bracket |
| 6b. Molded base assembly | |



BR-600C Series Handrail Installation Instructions

Architectural Products Division

- Step 1:** Determine top of handrail and snap a chalk line 3" below for centerline of mounting hardware, see **fig 1**.
- Important:** Store material in a clean dry place where the temperature is maintained between 50°F (10°C) and 100°F (38°C). Walls and rooms should be maintained at a minimum of 65°F (18°C) for at least 48 hours prior to installation. Acclimate materials to normal building conditions for at least 24 hours before cutting and installing.
- Step 2:** Cut aluminum retainer. See **Cutting Adjustment Diagrams and Schedule** for adjustments to aluminum retainer length at wall returns, inside corners, and outside corners. Refer to **Minimum Layout Configurations** for additional information.
- Important:** All cuts must be square and deburred.
- Step 3:** Drill aluminum for attachment of wood handrail and wood accessory tops. Use groove in retainer to locate centerline for drilling, see **fig 2**. Drilling must be perpendicular to aluminum as shown in **fig 3**. Use a #16 (.1770) drill bit to provide clearance for a #8 fastener. Deburr all holes as noted in **fig 3** to prevent interference with wood handrail and accessory tops.
- Mounting holes must be spaced:**
- At 1" and 3" from end of retainer for wall return and outside corner tops, see **fig 4**.
 - At 5" from end of retainer then not to exceed 12" on center for wood handrail at ends adjoining wall returns and outside corners, see **fig 5**.
 - At 1" in then not to exceed 12" on center from butt joint in wood handrail, see **step 13**.
- Step 4:** Mark and drill bracket mounting hole locations. Use groove in retainer to locate centerline for drilling, see **fig 6**.
- Bracket mounting holes must be spaced:**
- Not to exceed 32" on center
 - 1 1/2" to 6" from end of aluminum retainer at returns and corner accessories
 - A minimum of 4" from end of retainer at splices to avoid interference with splice hardware (shown in **fig 11**)
 - To align with horizontal metal backer plate or metal studs (by others)
- Step 5:** Locate and drill bracket mounting holes in wall construction using the aluminum retainer as a template or by careful measurement. Choice of hardware will dictate hole diameter.
- Step 6:** The outside corner base consists of a "left return" mold and an insert which is pressed into the opening of the primary mold at the factory. If this friction fit assembly loosens during shipment, press fit the insert to form an outside corner as shown in **fig 7**.
- Step 7:** Insert molded accessories in end of aluminum retainer, press firmly to ensure molded part is seated squarely against the retainer. Drill accessory mounting holes using the accessory as a template, see **fig 8**.
- Step 8:** Cut flexible cushion to length slightly shorter than aluminum and slide into retainer, see **fig 9**.
- Step 9:** Attach molded wall returns, and one side of molded outside corner and inside corner to retainer with accessory seated firmly and squarely while tightening. Fasten with 1/4" bolt, flat washer and nylon lock-nut provided.
- Caution:** Do not use a lock washer, use flat washers only. Always place a flat washer between nut and molded tab. Tighten to 10 ft-lbs maximum torque, see **fig 10**.
- Step 10:** Mount assembly to wall with the appropriate hardware according to wall construction. See **step 11** for splicing information. Work up to and around inside and outside corners from one side so aluminum may be slid into unattached side of corner base.
- Suggested hardware:**
- Drywall: Toggler® brand toggle bolts
 - Masonry: Plastic Alligator® insert
- Step 11:** Refer to **fig 11** for splicing of aluminum retainer as required on longer handrail lengths. Locate splice joints a minimum of 4" from bracket locations. Match drill through splice and retainer in 4 places using a 5/16" drill bit to provide clearance for 1/4" diameter hardware. Offset butt joints in wood handrail and bumper guard cover from joints in aluminum retainer.
- Step 12:** Install machined wood tops at wall returns and corners. Use care to position wood tops level on aluminum retainer. Secure in place using #8 self-drilling screws (provided) through holes drilled in **step 3**, see **fig 12**. Drill pilot hole in wood top for #8 fastener aligned on center with predrilled hole in aluminum retainer.
- Important:** The angle at which the screws are installed is critical, see **fig 3**. For best results drill a 1/8" diameter pilot hole for installation of the #8 fasteners.
- Step 13:** Measure between accessory tops and mitered corners. Cut wood handrail accordingly. Care should be taken to select the straightest lengths of wood for the longest handrail spans. Select wood of similar grain and color to best match accessories and when joining sections end to end. Color the perimeter of unfinished ends using a stain pen or touch-up stain, see **fig 13**.
- Important:** All cuts must be square and deburred. Use 120 grit sand paper on wood being careful not to damage the finish. To properly secure ends of rail, mounting holes must be provided 1" in from butt joint in wood handrail, see **step 3**.
- Step 14:** Install wood handrail using mounting holes drilled in **step 3** and **step 13**. Use care to position wood top level on aluminum retainer and aligned with accessory tops. Secure in place using #8 self-drilling screws provided, see **fig 12**. See **step 13** for important installation information.
- Step 15:** If optional vertical accents are being used snap fit them on aluminum retainer in locations desired. If accents are being used side-by-side slide them together after they are snapped in place so the interlocking teeth pass under the next accent in sequence. The teeth will interlock properly only when all accents are aligned the same way, see **fig 14**.
- Step 16:** Measure between textured surface of wall returns, corner accessories, and vertical accents (where used) and cut bumper guard cover to fit. Cover should extend 1/4" beyond ends of aluminum retainer to mate fully with the molded base, see **fig 8**. Offset butt joints in bumper guard cover from joints in aluminum retainer.
- Step 17:** Install bumper guard cover by inserting tab behind the wood handrail and rotating into place until hook snaps over the bottom edge of the aluminum retainer. Do not align joints in cover with joints in retainer.

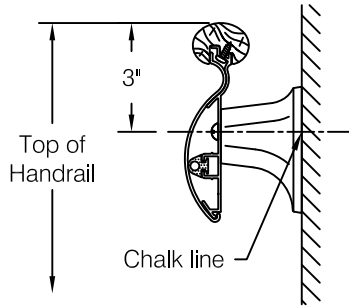

fig 1

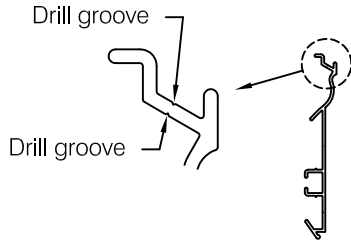

fig 2

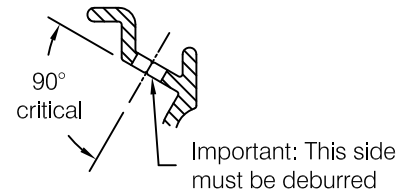

fig 3

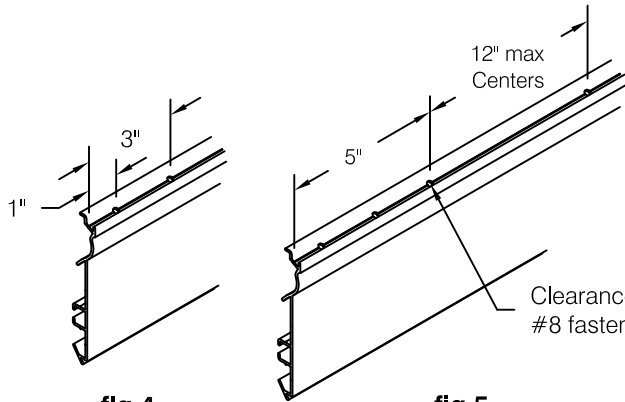

fig 4

fig 5

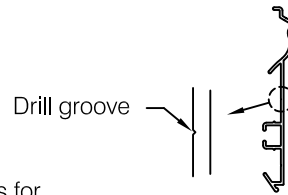

fig 6

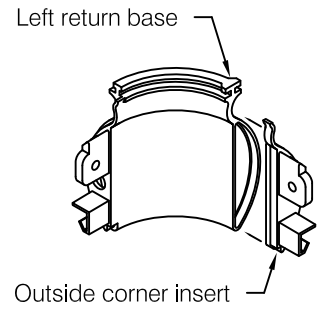

fig 7

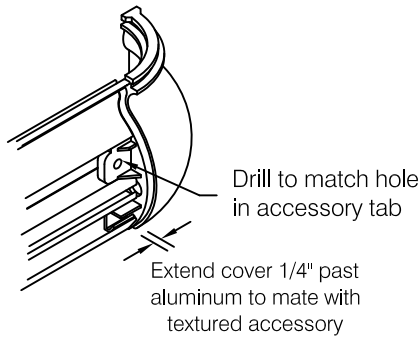

fig 8

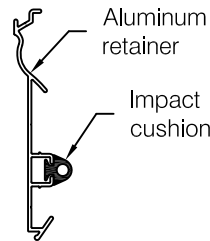

fig 9

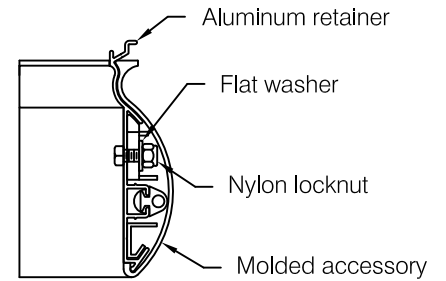

fig 10

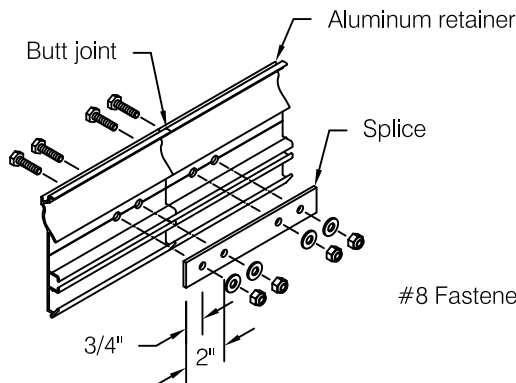

fig 11

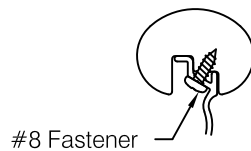

fig 12

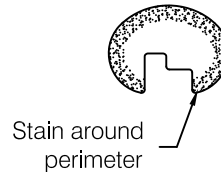

fig 13

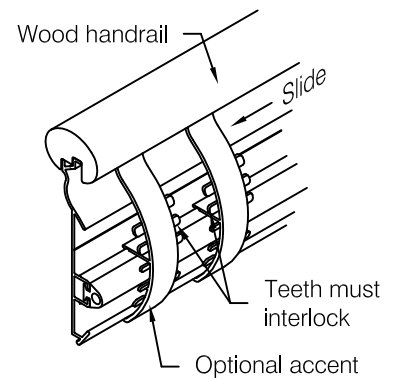
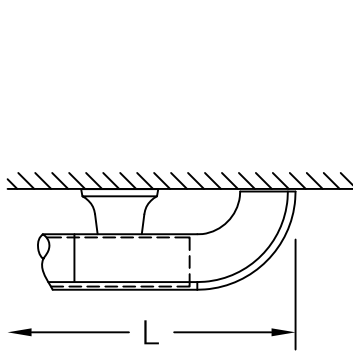
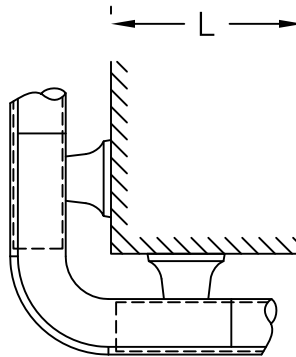

fig 14

Cutting Adjustment Diagrams and Schedule



Return



Outside Corner

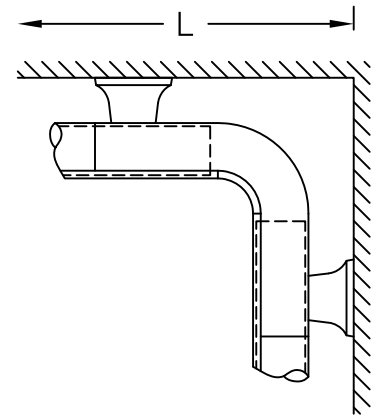

Inside Corner

	Aluminum Retainer	Snap-on Cover
Return	L - 3 7/16"	L - 3 3/16"
Outside Corner	L - 3/16"	L + 1/16"
Inside Corner	L - 4 11/16"	L - 4 7/16"

Important: Install aluminum retainer and molded accessories before cutting the snap-on cover.

Minimum Layout Configurations

