

CG-510A Flush Mount Corner Guard

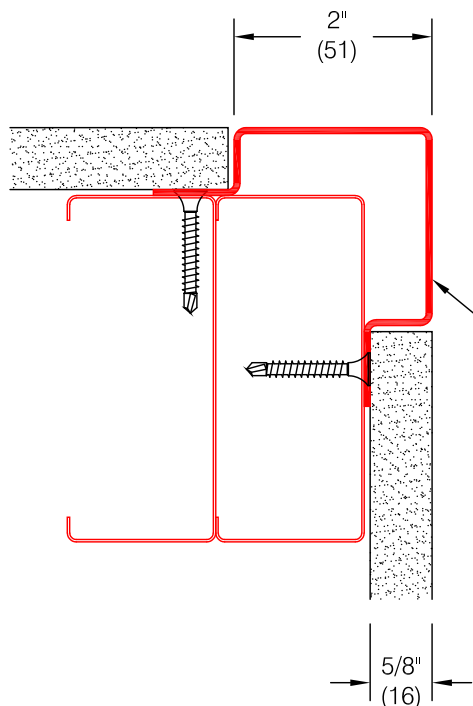

Formed Aluminum

- type T5052
- mill finish
- 0.080" (2.0)

Features:

- Stock lengths: 4'-0" (1219) & 8'-0" (2438)
10'-0" (3048)
- Aluminum T5052
- Custom lengths and wing sizes are available

Mounting Options:

- Standard mounting
- Adhesive:
ADH-50 adhesive supplied separately
- Optional mounting
- Drilled:
Clearance holes for #8 fastener

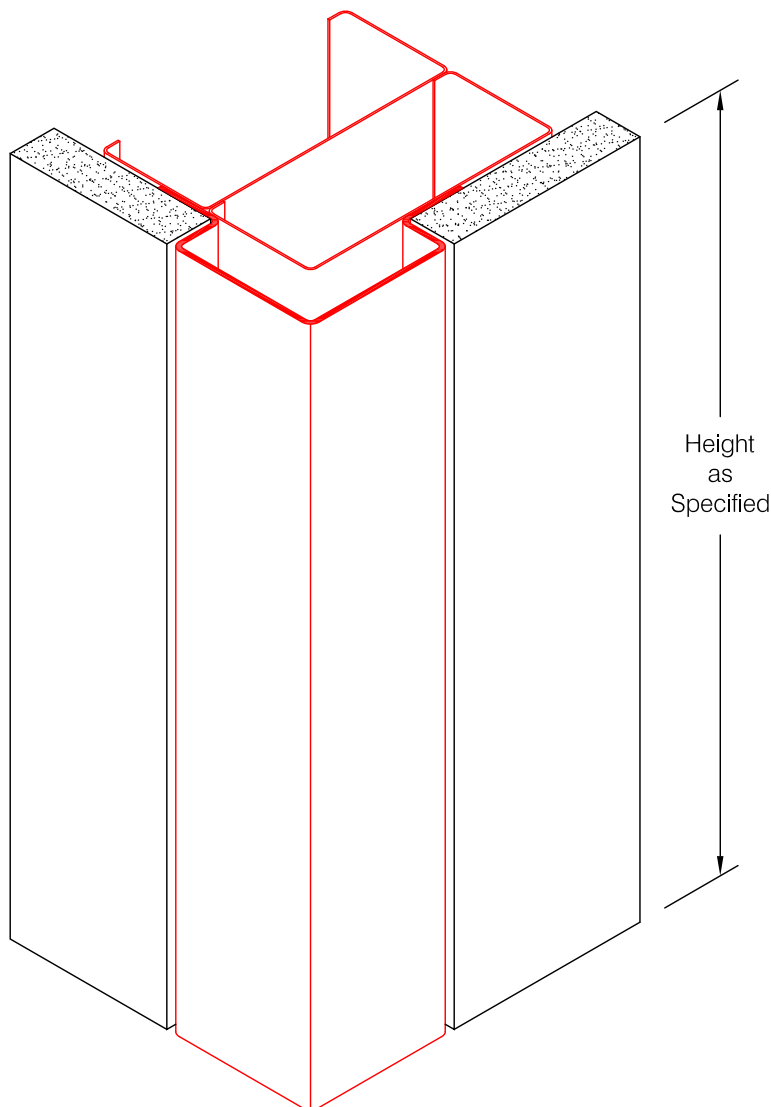

Pawling Corporation reserves the right to discontinue a design or modify an existing design without prior notice

Customer :

Project :

Architect :

Sales Rep :

WD.260.1