

# CG-400 Aluminum Corner Guard

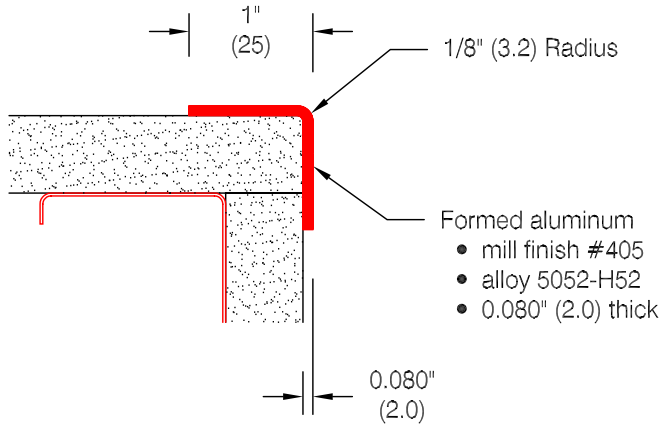

*Features:*

- Custom lengths, angles, and wing sizes are available
- Available for 135° corners (see WD.130.0)
- Stock lengths: 4'-0" (1219) & 8'-0" (2438)

*Mounting Options:*

- Standard mounting
- Adhesive:  
 ADH-50 adhesive supplied separately

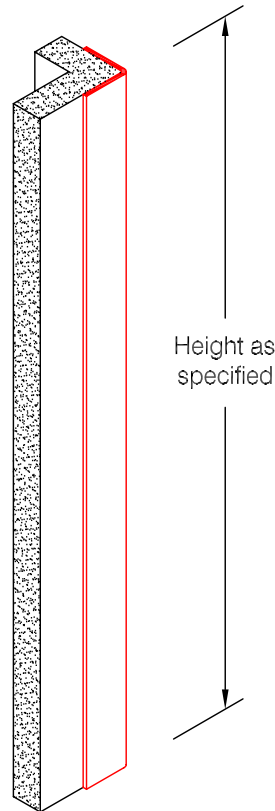

*Pawling Corporation reserves the right to discontinue a design or modify an existing design without prior notice*

Customer :	Project :	WD.127.0a
Architect :	Sales Rep :	