

MRF-1005 Bronze Recessed Frame

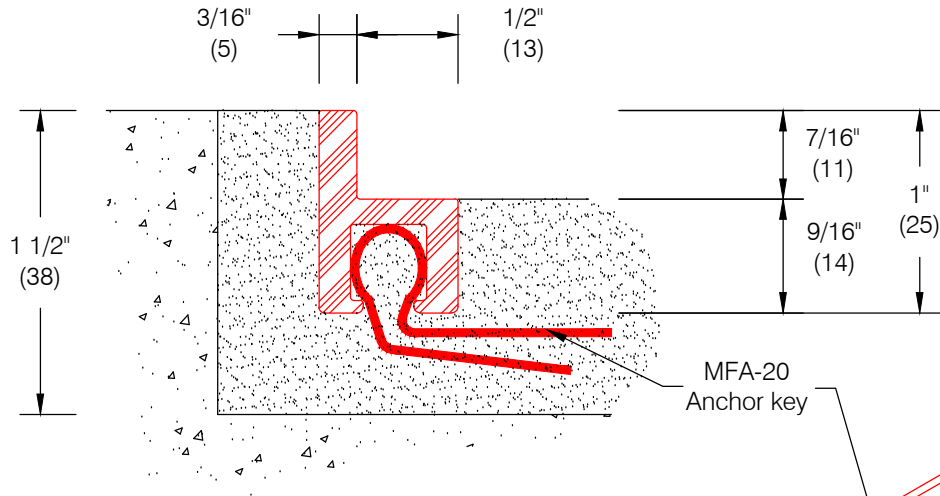

Features:

- Use for Rol-Dek[®] or other 3/8" (10) through 5/8" (16) thick mats
- Extruded architectural bronze alloy 385
- Stock length: 12'-3" (3734)
- Weight: 1.0 lbs / lf

Installation Options:

- Recessed, cast in place

Standard Finishes:

- Mill Finish #405

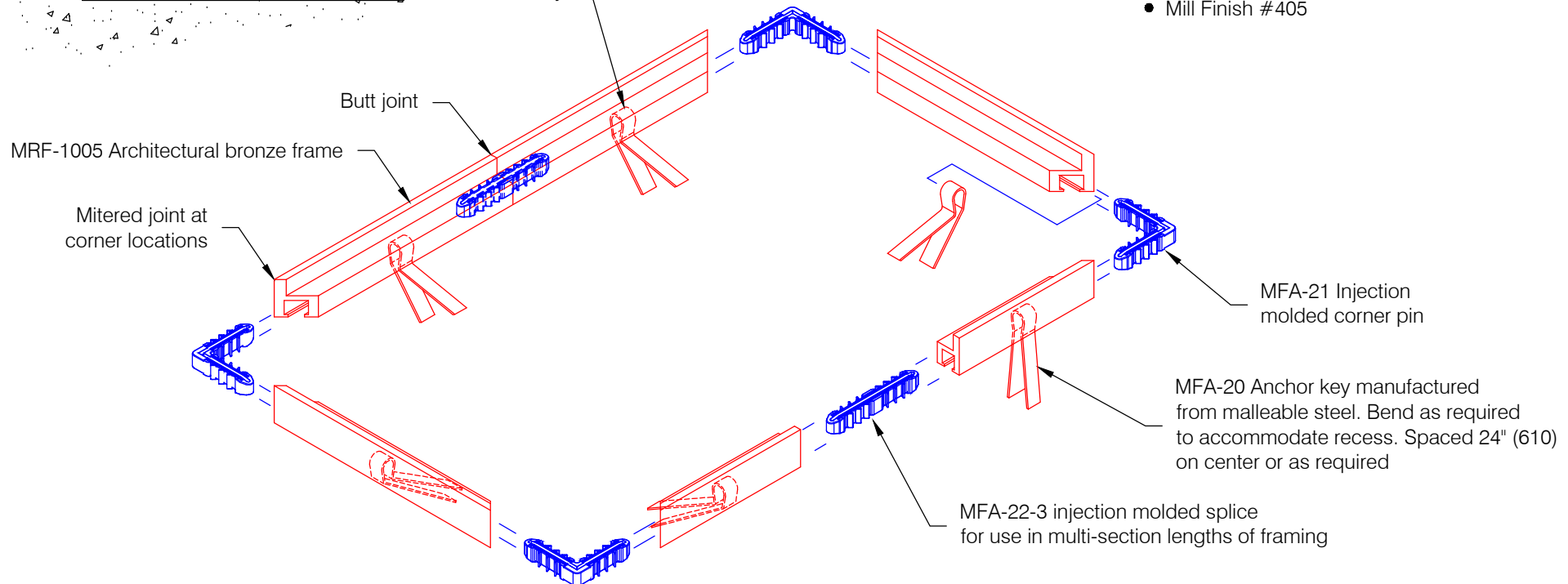

Pawling Corporation reserves the right to discontinue a design or modify an existing design without prior notice

Customer :

Project :

Architect :

Sales Rep :

ED.2.0b